



KEOPS

Five Bedroom Mobile Home
Guillemot

Gable size: 6500mm
Eaves size: 19700mm
Roof: Apex/ridge 14°
Internal Height: 3016mm
Bedrooms: Five
Bathrooms: Three

Keops Interlock
Five Oaks Farm
Sheriffs Lench, Evesham
Worcestershire
WR11 4SN
*Viewing by appointment



01386 861961
07943 184992
logcabins.co.uk
enquiries@logcabins.co.uk



PEFC
CERTIFIED

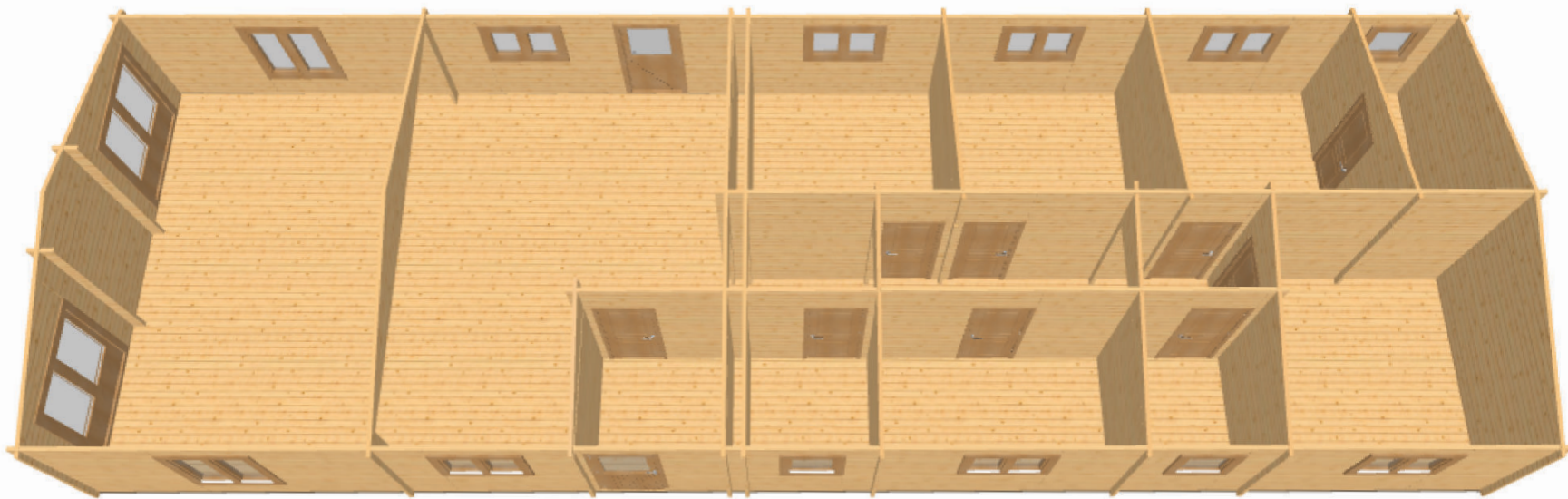

KEOPS

Five Bedroom Mobile Home
Guillemot

Gable size: 6500mm
Eaves size: 19700mm
Roof: Apex/ridge 14°
Internal Height: 3016mm
Bedrooms: Five
Bathrooms: Three

Keops Interlock
Five Oaks Farm
Sheriffs Lench, Evesham
Worcestershire
WR11 4SN
*Viewing by appointment



01386 861961
07943 184992

logcabins.co.uk
enquiries@logcabins.co.uk



PEFC
CERTIFIED

Keops Interlock 'Guillemot'

Five bedroom caravan/mobile home 6.5m x 19.7m

Specification

6500mm gable x 19700mm eaves

56mm log thickness

Apex/ridge roof

Felt roof shingles in a choice of black, brown, green or red

19mm pine tongue & groove vaulted ceiling

Structural timber chassis

19mm pine tongue & groove wooden floor

Partition walls as shown on plan

2 x WDE12 Premium single door ½ glazed with 24mm double glazing

2 x WDD34 Premium double door ¾ glazed with 24mm double glazing

7 x WRG Premium tilt & turn double windows with 24mm double glazing

2 x WRGL Premium tilt & turn tall double windows with 24mm double glazing

3 x WRM Premium tilt & turn single windows with 24mm double glazing

9 x WDB00 Premium interior pine doors

Comfort grade roof insulation

Comfort grade floor insulation

Gutter system

Box skirting

Delivery with forklift offload

Assembly onto suitable ready base

Special price - £85,500 including 5% VAT (England & Wales)

